

Urgent Field Safety Notice

MY-FSN-RDS-Corelab-2025-006

RDS/ Corelab
Erica Yong
Version 1
16 December 2025

cobas c 703 Reaction Cell Wash Units Premature Tubing failure

Product Name	cobas c 703 Analytical Unit
BASIC UDI-DI/GMMI / Part No	09502971001
Production Identifier (Lot No./Serial No.)	All Serial numbers from 2401-01 onward
SW Version	Not applicable
Type of Action	Field Safety Corrective Action (FSCA)

Dear Valued Customer,

Description of Situation

We have received complaints that identified an issue in which there has been premature deterioration to the tubing of the Reaction Cell Wash units for the cobas c 703 Analytical Unit. An investigation into the washing operations of the Reaction Cells Wash Unit tubing (also known as Rinse Joint 1-3) revealed the occurrence of pinholes during regular usage of the analytical unit. The pinholes are limited to the tubings exposed to Basic wash (2C which is used for Basic Wash aspiration, and 3A, which is used for Basic Wash dispensing).

In the event of damaged tubing, Basic Wash may drip into other Reaction Cells, potentially causing incorrect test results.

The medical risk attributable to incorrect test results depends significantly on the constellation of diagnostic and clinical parameters such as the degree of analytical variation of affected results, detectability by technical indices, detectability due to clinical implausibility, additional diagnostic testing results and congruence of the overall clinical picture. Together, in specific clinical scenarios, it is possible that clinical care could be influenced by incorrect test results, potentially causing adverse health consequences for patients, and therefore a medical risk cannot be excluded.

cobas c 703 Reaction Cell Wash Units Premature Tubing failure

No harm to patients or adverse events has been reported regarding this issue

Actions taken by Roche Diagnostics

To prevent occurrences of premature deterioration to the Reaction Cells Wash tubing Roche Diagnostics' Service Team will schedule additional service visits to replace tubing that is older than 6 months. A Corrective and Preventive Action (CAPA) investigation has been initiated, and the root cause investigation continues. Once the root cause analysis is complete, appropriate corrective and preventive measures will be defined and communicated, as needed.

Actions to be taken by the customer/user

- Customers can continue to use the affected device but should perform a visual check of the rinse tubing immediately.
- In addition, please perform a visual check of the Reaction Cells Wash tubing when executing the monthly operator maintenance action "Replace Reaction Cells". **Please refer to the following attachment to FSN version1.**
- In case you identify any damage on the tubing, please report the damage to your local Roche Service Representative
- No general recommendations with respect to the review of previous results can be given by using the cobas c 703 analytical unit. Customers should follow their standard laboratory operating procedures. Any specific questions raised by the users should be addressed individually, considering all relevant clinical information.

Communication of this Field Safety Notice

This notice must be passed on to all those who need to be aware within your organization or to any organization/individual where the potentially affected devices have been distributed/supplied.

Please transfer this notice to other organizations/individuals on which this action has an impact.

Please maintain awareness of this notice and resulting action for an appropriate period to ensure the effectiveness of the corrective action.

cobas c 703 Reaction Cell Wash Units Premature Tubing failure

Important Information

1. The affected device can continue to be used. Please perform an immediate visual check of the rinse tubing
2. Inspect the Reaction Cells Wash tubing during the monthly “**Replace Reaction Cells**” maintenance according to the **Attachment FSN version 1**.
3. If any tubing damage is observed, please report it to your local Roche Service Representative.

Actions Required

1. Please complete the Customer Acknowledgment Receipt within 2 business days via the navify® Portal: Product and Safety Care to confirm that you have read and understood this notice.

Contact

If you have any questions, please do not hesitate to contact your sales representative or our Customer Call Centre: 1800 88 8881

Thank you.

Best regards,
ROCHE DIAGNOCTIS (M) SDN. BHD.



Erica Yong
CPS Marketing Partner
Email: erica.yong@roche.com



Ong Yean Ting
Head of Regulatory Affairs & Quality
Email: yeon_ting.ong@roche.com

New monthly check of cell rinse tubes on the c 703 Analytical Unit

Dear customers,

An issue has been identified in which there has been premature damage to the tubing of the Reaction Cell Wash units for the cobas c 703 Analytical Unit.

To prevent occurrences of premature damage to the Reaction Cells Wash tubing Roche Diagnostics' Service Team will schedule additional service visits to replace tubing every 6 months.

In addition the monthly customer maintenance schedule was adjusted to allow for more frequent inspection of the rinse tubes. This new monthly customer maintenance is a visual check of the Reaction Cells Wash tubing when executing the monthly operator maintenance action "Replace Reaction Cells". In case you identify any damage on the tubing, please report the damage to your local Roche Service Representative.

Step 1

The c 703 module is in maintenance action "Replace Reaction Cells".

Step 2

Open the top main cover of c 703 module.

Step 3

Check the tubes on all three rinse stations.

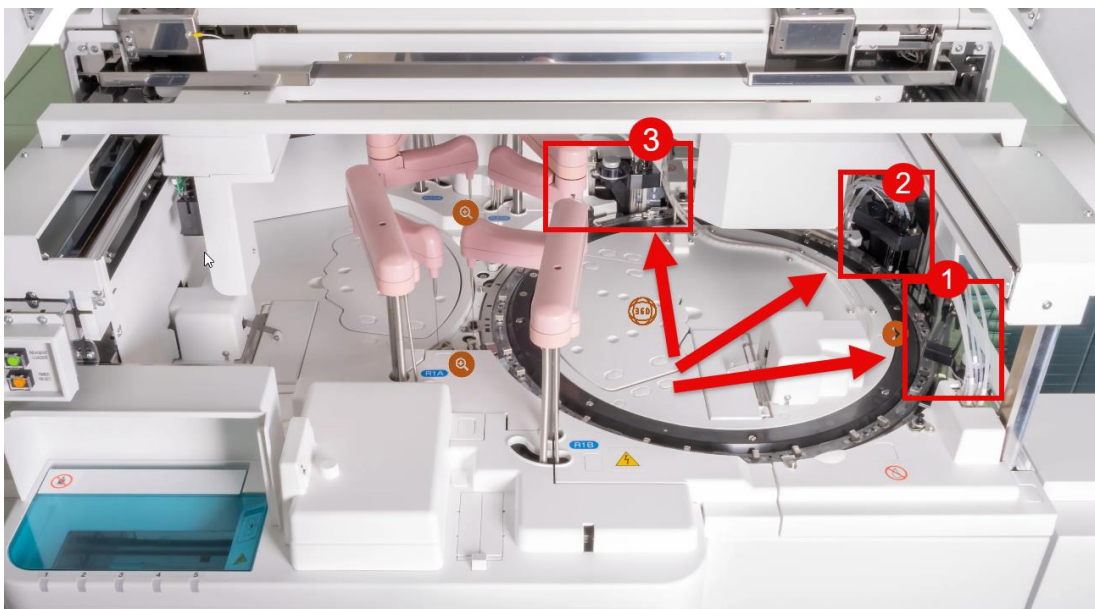

Overview of Rinse station 1-3

Step 4

Check the tubes of **Rinse station 1** for any damages on the whole length. The most critical part is the connection between tube and needle (see red box in the picture).



Overview of Rinse station 1

Step 5

Check the tubes of **Rinse station 2** for any damages on the whole length. The most critical part is the connection between tube and needle (see red box in the picture).



Overview of Rinse station 2

Step 6

Check the tubes of **Rinse station 3** for any damages on the whole length. The most critical part is the connection between tube and needle (see red box in the picture).



Overview of Rinse station 3

Step 7

If you find any damage on the tubes of Rinse station 1-3, please contact your local Roche Service Representative immediately.

Step 8

Finish the monthly maintenance “Replace Reaction Cells” and close the main cover of c 703.

Step 9

END

With kind regards

ROCHE DIAGNOCTIS (M) SDN. BHD.